

# Surface mounted corner support - $\varnothing 6$ mm pins

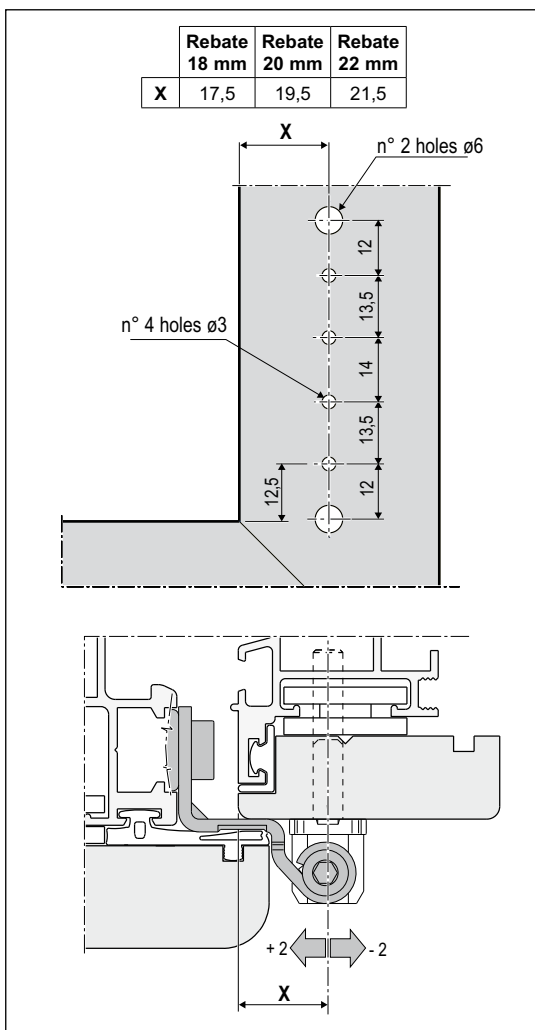
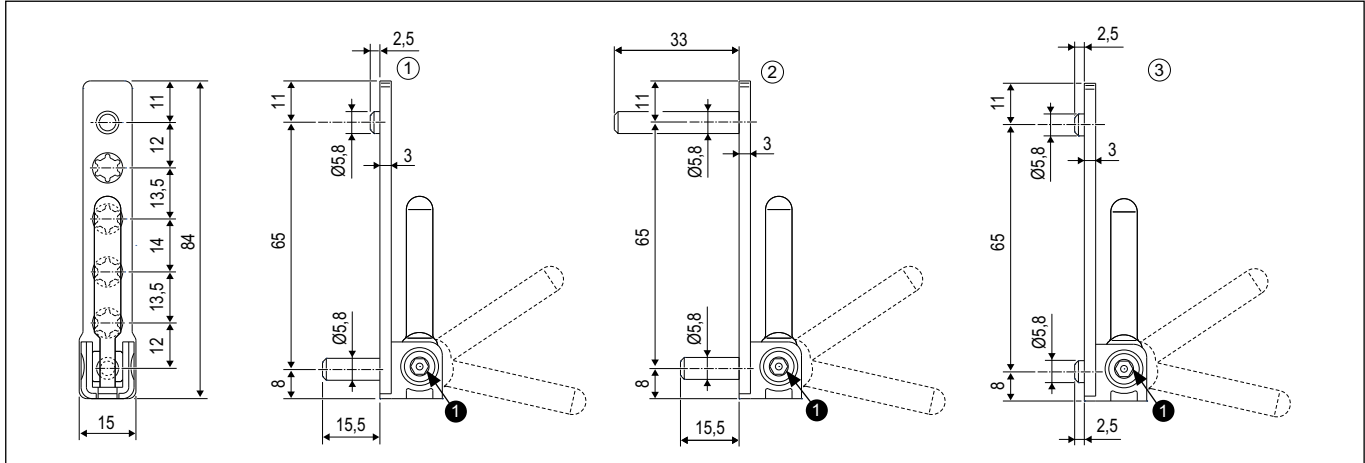
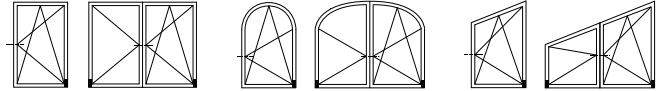
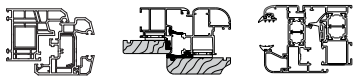

### Description

Adjustable corner hinge support, non-handed, to apply on the frame jamb, with  $\varnothing 5,8$  mm pins.

Pins available in 3 different lengths:

- ① 2,5 mm above and 15,5 mm below;
- ② 33 mm above and 15,5 mm below;
- ③ 2,5 mm above and 2,5 mm below.

Designed to have holes in symmetry with stay support A50712.00.00.

### Application

Use the version with pins measuring 2,5 mm above and 15,5 mm below in PVC windows when the metal reinforcement inside the frame could interfere with the top pin.

Use the version with pins measuring 33 mm above and 15,5 mm below for aluminium windows that have a mounting bracket in the angle.

Use the version with 2.5 mm long pins only when the inner part of the profile has an iron reinforcement and thus adequate mounting is ensured using the screws only.

Couple with the following components based on the window material:

- surface mounted hinge art.A50911.XX.XX;
- female hinge for PVC, A50922.07.00.

### Adjustment

The following sash adjustments can be made using a 4 mm hexagonal wrench:

- horizontal adjustment  $\pm 2$  mm ①;
- pressure adjustment (on female part);
- vertical adjustment (on female part).

### Mounting

3.5/4.3x25 mm screws, with thread suited to material used for frame construction.

**Note.** Use jig A52099.00.02 for drilling hole.

### Order Specifications

| Ref. | Article      |
|------|--------------|
| ①    | A50815.07.00 |
| ②    | A50814.07.00 |
| ③    | A50812.07.00 |