

Electric striker for Opera SL and Sicurezza SL for rebated doors, half lip with telescopic coverplate - 22x238 mm forend



Description

Pre-assembled steel striker with electric device.

Application

Electric striker for Opera SL, Sicurezza SL and Sicurezza 2.0 for rebated doors with half lip with telescopic coverplate (30x96 mm), pre-assembled with electric device. Moving the latch cover-tray, it is possible to adjust the door in pressure. For further information, please consult the page of the electric device installed.

Fastening

Apply the striker flush to the edge and fasten with 2 screws $\varnothing 4$ mm of a suitable length.

Attention!

Security latch of Opera SL locks works only with gap between 2 and 5 mm.

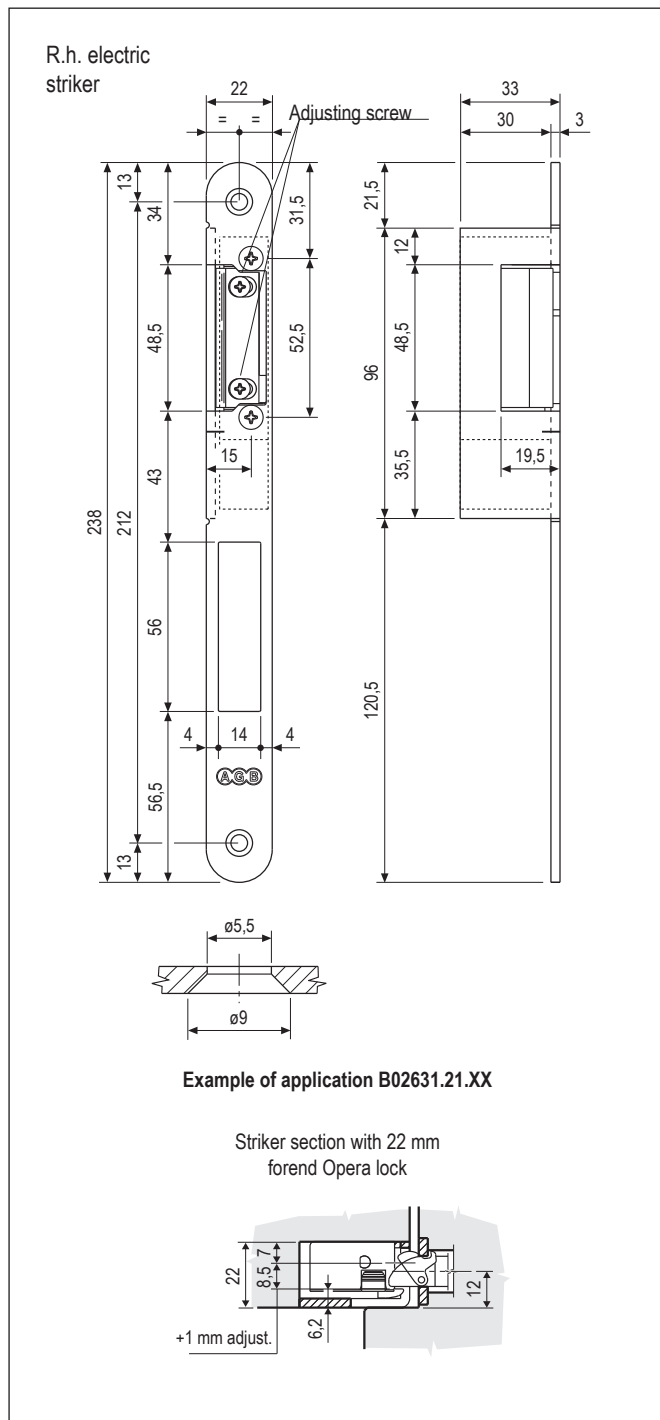

Order Specifications

Article	Type	Repeater	Manual release lever	Electric device
B02631.21.XX	rh	NO	NO	B02600.20.01
B02632.21.XX	lh	NO	NO	B02600.20.01
B02631.22.XX	rh	NO	YES	B02600.20.02
B02632.22.XX	lh	NO	YES	B02600.20.02
B02631.31.XX	rh	YES	NO	B02600.21.01
B02632.31.XX	lh	YES	NO	B02600.21.01
B02631.32.XX	rh	YES	YES	B02600.21.02
B02632.32.XX	lh	YES	YES	B02600.21.02
B02631.01.XX	rh	NO	NO	B02600.01.02
B02632.01.XX	lh	NO	NO	B02600.01.01
B02631.03.XX	rh	YES	NO	B02600.03.02
B02632.03.XX	lh	YES	NO	B02600.03.01
B02631.04.XX	rh	YES	YES	B02600.04.02
B02632.04.XX	lh	YES	YES	B02600.04.01
B02631.05.XX	rh	NO	NO	B02600.05.02
B02632.05.XX	lh	NO	NO	B02600.05.01

“R.h.” and “l.h.” refer to pull doors according to DIN 107 regulation. For security reasons, in hotels we suggest to use the strikers without repeater and without manual release lever. Refer to the price list in force in order to check the availability of the finishes.

Electronic device data table (collected at 20° C)

	B02600.01.OX B02600.03.OX B02600.04.OX B02600.05.OX	B02600.21.OX	B02600.20.OX
	-	WITH repeater	WITHOUT repeater
Tension	12V	10V - 24V	10V - 24V
Extended power	-	11V-13V ≡ DC	11V-13V ≡ DC
Nominal resistance	7,7 Ω	43 Ω	43 Ω
≡ DC absorption (stabilized)	(12V) 1560 mA (24V) 1560 mA	280 mA 560 mA	280 mA 560 mA
~ AC absorption	(12V) 1100 mA (24V) 1100 mA	250 mA 500 mA	250 mA 500 mA
Max latch preloading ≡ DC (stabilized)	(12V) 30N (24V) 30N	45N	50N
Max latch preloading ~ AC	(12V) 120N (24V) 120N	45N	200N
Antiburglar resistance	3000N	3750N	3750N

Note. On doors with high acoustic abatement we suggest the use with 12V ~ AC or 24V ≡ DC.